

# THOMPSON HEIGHTS



RIVER FALLS, WI



Coho



Sockeye

	Coho
	Sockeye
	Reserved
	Sold
	Model



\*Subject to change without notice

# THOMPSON HEIGHTS

RIVER FALLS, WI



**DERRICK**  
Custom Homes

<u>Lot</u>	<u>Premium</u>
1	(\$10,000)
2	(\$10,000)
3	(\$7,500)
4	(\$7,500)
5	\$0
6	\$0
7	\$0
8	\$0
9	\$0
10	\$0
11	\$0
12	\$0
13	\$0
14	\$0
15	\$0
16	\$0
17	\$0
18	\$0
19	\$0
20	\$0
21	\$0
22	\$0
23	\$0
24	\$0
25	\$0
26	\$5,000
27	\$5,000
28	\$5,000
29	\$7,500

<u>Lot</u>	<u>Premium</u>
30	\$10,000
31	\$7,500
32	\$7,500
33	\$10,000
34	\$10,000
35	\$10,000
36	\$5,000
37	\$10,000
38	\$10,000
39	\$10,000
40	\$10,000
41	\$10,000
42	\$10,000
43	\$10,000
44	\$5,000
45	\$2,500
46	\$5,000
47	\$5,000
48	\$5,000
49	\$5,000
50	\$5,000
51	\$5,000
52	\$5,000
53	\$5,000
54	\$5,000
55	\$5,000
56	\$5,000
57	\$5,000
58	\$5,000

<u>Lot</u>	<u>Premium</u>
59	\$0
60	(\$5,000)
61	(\$10,000)
62	(\$10,000)
63	(\$10,000)
64	(\$10,000)
65	(\$10,000)
66	(\$10,000)
67	(\$10,000)
68	(\$10,000)
69	\$0
70	\$0
71	\$0
72	\$0
73	\$0
74	\$0
75	\$0
76	\$0
77	\$5,000
78	\$5,000
79	\$7,500
80	\$7,500
81	\$7,500
82	\$7,500
83	\$7,500
84	\$7,500
85	\$0
86	\$0

\*Premiums Subject to Change Without Notice

# THOMPSON HEIGHTS

RIVER FALLS, WI



Coho



Sockeye

	Coho
	Sockeye
	Reserved
	Sold
	Model

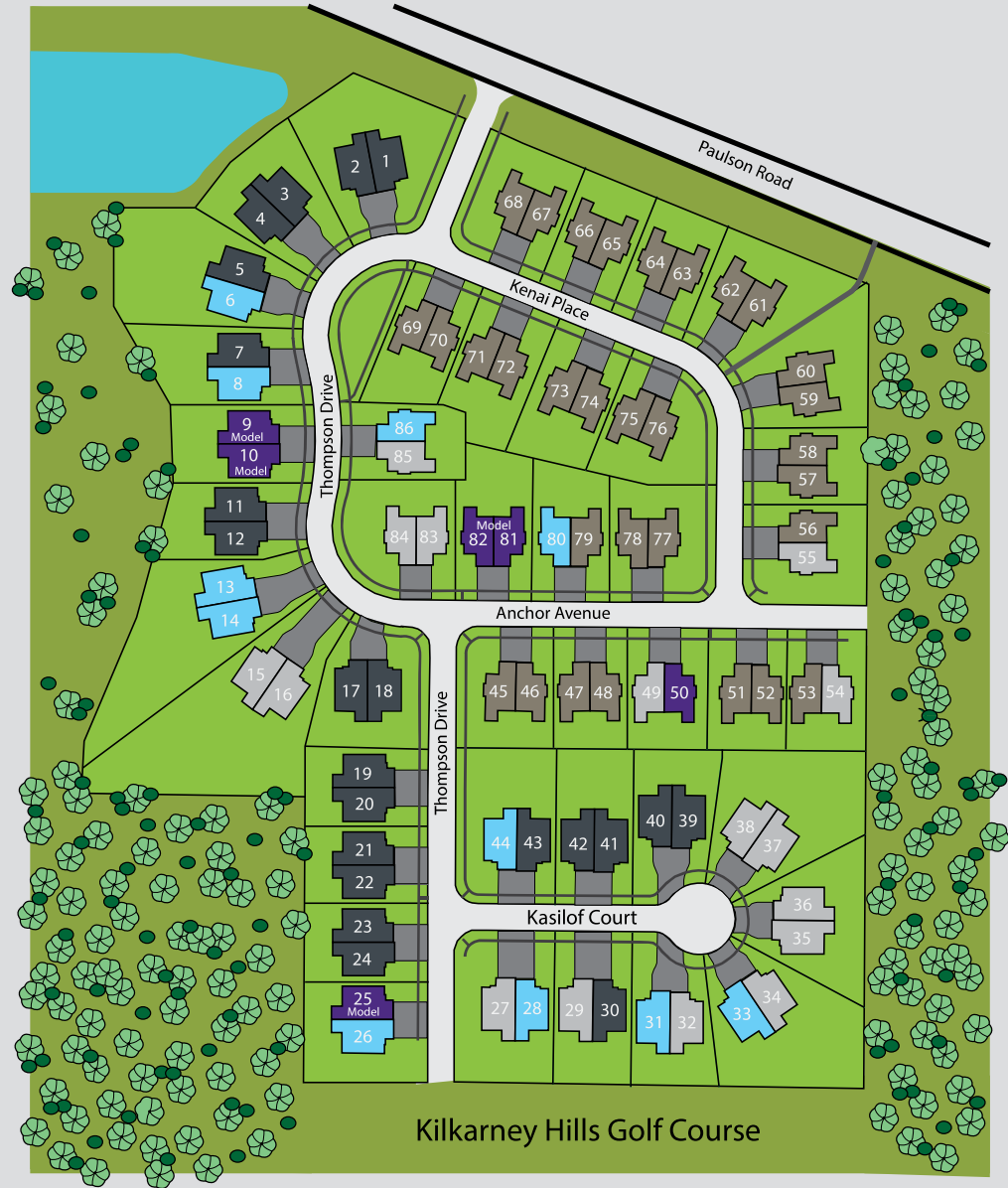

\*Subject to change without notice